

# HDL®

## Always in the know

Keep up to date with what happens at home and avoid nasty surprises. If smoke is detected, a window opened, or an intruder sensed, IntelliCenter can instantly notify you.

Able to be fully customized you can select the update alerts you want to receive, so what matters most to you is always given priority.

With messages sent directly to your management app, as long as you have your iOS or Android device on hand you will always be up to date.

## No internet, no app, no problem

Sometimes life's better when it's simplified.

That's why IntelliCenter can function as a smart gateway even when it's not connected to the internet.

This means if you don't want to use your phone, or you don't have an active data connection, your smart home will stay smart.

Ideal for holiday homes and off grid properties, you can retain the efficiency of automation without compromising the way you want to live.

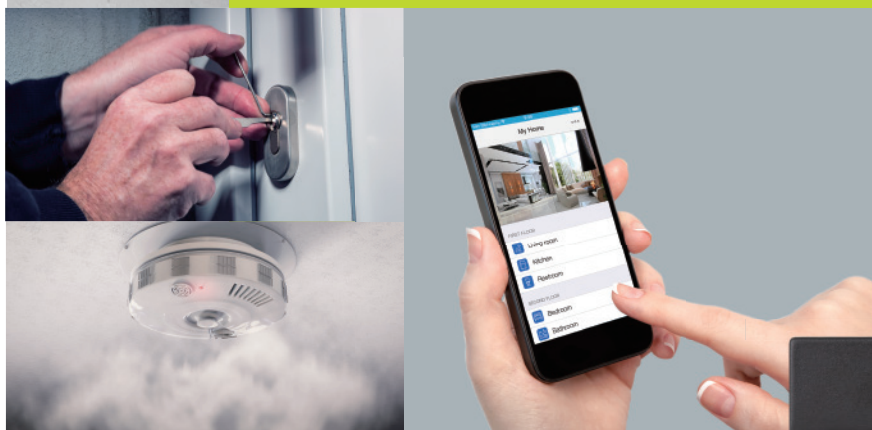

## Zero downtime

More powerful and versatile than any other smart gateway currently available, IntelliCenter is able to remain active 24 hours a day, 7 days a week. Utilizing Always On Technology, IntelliCenter has been designed for maximum reliability and operability.

Because IntelliCenter was created to always be on, it will never need to be restarted, reset, or shutdown. This means that once your IntelliCenter is installed, the only time it won't be able to connect you to your home is in the event of a power outage.

24h

7

[www.hdlautomation.com](http://www.hdlautomation.com)

[sales@hdlautomation.com](mailto:sales@hdlautomation.com)



HDL Automation

# IntelliCenter

The evolution of home automation.







## One for all, and all for one

IntelliCenter makes your home truly smart. By being able to 'talk' to products and devices from other automation manufacturers, IntelliCenter is able to create a single centrally controlled home automation system.

This groundbreaking technology means that whatever existing sensors, user interfaces, and control modules you have in your home they will always work in harmony with each other.

What's more, as the different systems are unified you can control, configure, and monitor all of your smart devices from a single app – no more switching between apps and remote controls. Just run the iRidium lite app for simple and effective management.

## Always up to date

Technology is constantly evolving, and so is IntelliCenter. With HDL and iRidium engineers working to expand IntelliCenter's protocol base, your HDL system will always be up to date with the latest developments in automation.

This constant progression in IntelliCenter functionality means that not only is your installation guaranteed to be future-proof, but it is also able to remain supremely adaptable and flexible.

In the unlikely event your chosen protocol isn't currently supported by IntelliCenter, let us know and we will include it into the IntelliCenter Protocol Support Plan.



## Your place, my place, any place

IntelliCenter makes it easier and more intuitive to control your living space.

It doesn't matter if you're in your living room, or on a beach the other side of the world, you can always stay connected to your home.

Able to securely link to your home management app, IntelliCenter lets you monitor security cameras, control your connected devices, and check your front door is closed from any iOS or Android device.

Whether it's looking in on your pet while you're at work, or making sure the lights are turned off when you're on holiday, IntelliCenter has you covered.

## Better Together

HDL IntelliCenter gives a new meaning to the word connectivity. Able to bring together multiple automation protocols to create a single unified system, IntelliCenter makes complete home control effortless.

Powerful hardware, and constantly evolving software, combine to bridge the gap between different automation products.

Future-proof, simple to use, and utterly reliable, IntelliCenter is a leap forward in how you experience your home's smart devices.

